

Parking Ordinance No. 3309

Consent Agenda Item

Changing Parking in Four Areas

- No parking times around DISD Cabell Elementary School.
- No parking times next to CFBISD Montgomery Elementary School.
- Permitting parking on Valwood Parkway from Dennis Lane to Webb Chapel Rd.
- No parking for part of Damascus Way near Webb Chapel Rd.

NO
PARKING
→
7:00-8:15
3:00-3:30

SCHOOL
DAYS

STUDENT
LOADING
AND
UNLOADING



EXCEPT
SCHOOL BUS



Cabell Elementary School



Montgomery Elementary School



Proposed No Parking Zones

Valwood (Dennis to Webb Chapel)

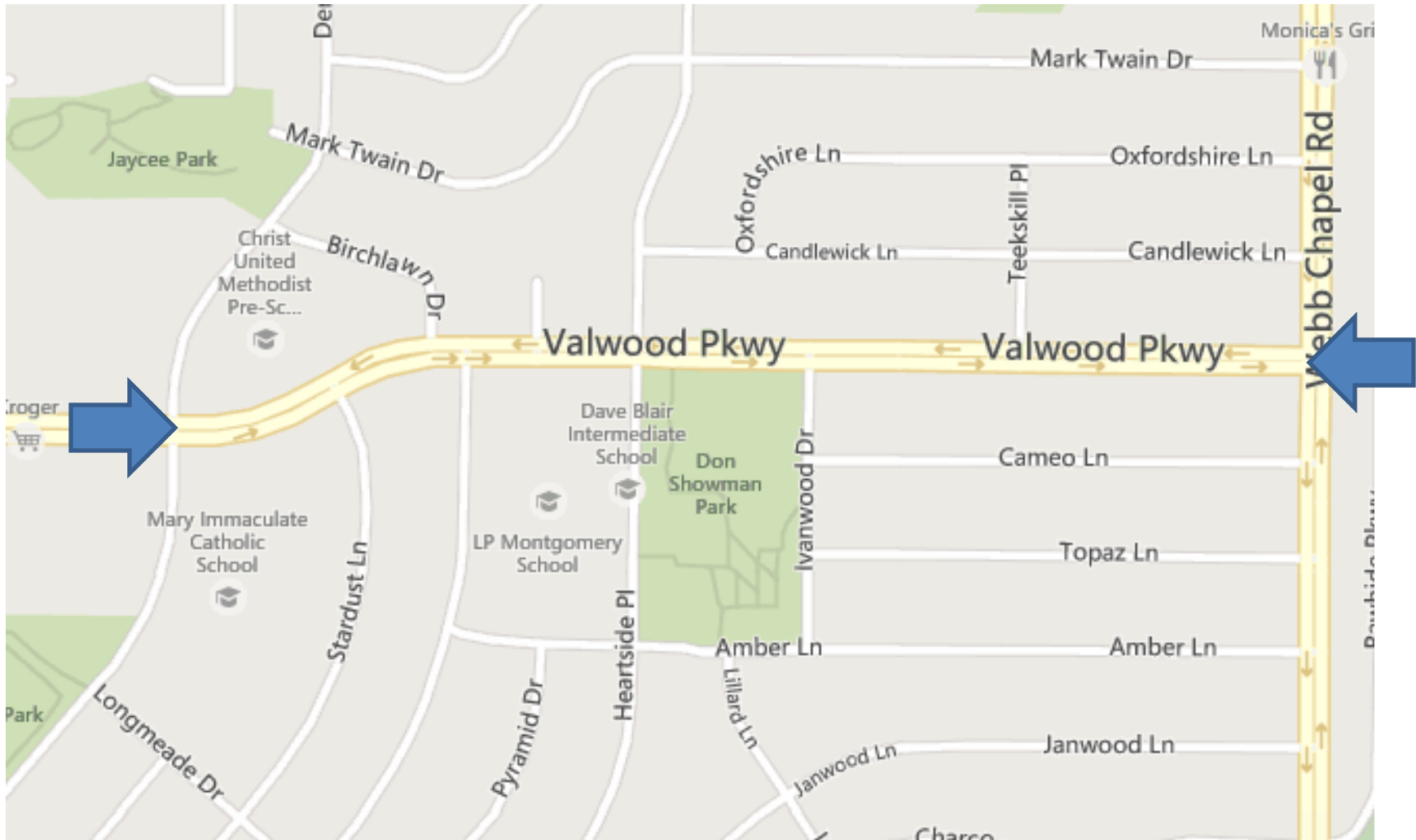



END
SCHOOL
SPEED
LIMIT

YOUR
SPEED
37

Damascus (Parking Survey)

- 39 properties on this block. (Total)
- 32 surveys completed. 82% of Total
 - 21 responded “Yes or Sometimes” – 66% of respondents / 53% of Total
 - 11 responded “No” – 34% of respondents / 28 % of Total

VIEW DR.

CHAPEL DR.

WEBB CHAPEL RD.

BRINCREST DR.

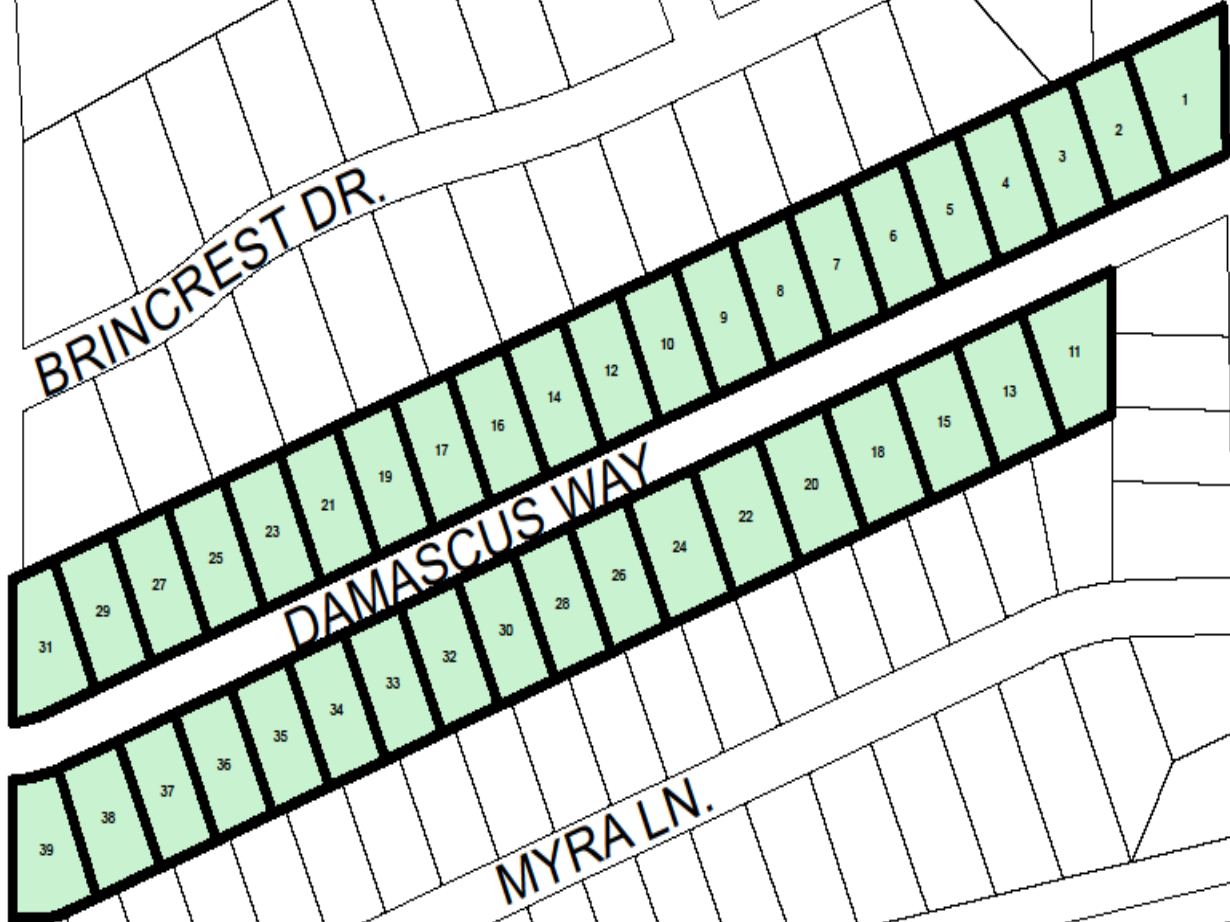

DAMASCUS WAY

MYRA LN.

NORTH

EUNICE ST.

BRISBANE AVE.

Proposed No Parking Zones

Damascus Way

Webb Chapel Rd



- Ordinance No. 3309 is on the Consent Agenda
- City Administration recommends adoption of Ordinance No. 3309