



DEERSKIN MFG. INC.
PO BOX 127 SPRINGTOWN, TEXAS 76082
(800) 880-6089 FAX (817) 523-6685
www.deerskinmfg.com

Custom Adoption Trailer 16 Dog Cages/6 Cat Cages

A custom built bumper pull trailer is approximately 8' x 18' (cargo capacity) and 8' x 21' (overall) with a height of 7 1/2' to accommodate 22 animal cages. The animals are viewable by the public from the outside of the trailer through the 1/4" clear lexan doors. The adoption trailer is built to the following specifications: There will be a sealant around the door frame to prevent debris from collecting between door frame and lexan.

Framing

- Basic floor framing is 2" x 2" x 14 gauge square steel tubing welded.
- Chassis is 5" steel channel welded
- Superstructure is all aluminum channels welded and .125-3" radius aluminum corners.
-

Insulation

- All walls, floor and roof have 2" foam insulation

Interior Features

- Floor of trailer is 125 aluminum tread bright with water tight seams
- Interior walls are 125 white FRP (fiberglass reinforced panels) or 040 white aluminum
- Interior ceiling is 040 white aluminum
- Interior lights are 7" scene lights with conventional switches. There are 4 located in the ceiling and 2 located on the right wall.
- Stainless steel cabinet and sink with water hose connection
- Top of cages can be used as storage shelf
- Desk area at front of trailer

Animal Cages

- Larger animal cages are 23" wide x 36" deep x 30" tall
- Animal cages are constructed of 1x1 stainless steel tubing welded and 20 gauge stainless steel partitions. The floors are 14 gauge stainless steel with 2" stainless steel drains



DEERSKIN MFG. INC.
PO BOX 127 SPRINGTOWN, TEXAS 76082
(800) 880-6089 FAX (817) 523-6685
www.deerskinmfg.com

- All animal cages drain into a 35 gallon holding tank located under the trailer with a 3" RV dump valve.
- Animal cage floors have PVC grid in all cages to keep animals dry
- Animal cage doors are constructed of 125 punched aluminum inside and aluminum framed ¼" clear lexan outside
- Animal cages are on slide out "banks".
- Smaller animal cages are 20" wide x 36" deep x 20" tall

Exterior Features

- Exterior walls and roof are 080 white aluminum
- Lower storage compartment at rear left side
- Exterior running lights meet all DOT lighting requirements
- Right side RV "Personnel" door with folding step and folding grab handle
- Rear loading door with ramp
- Rear Wall Ladder
- Roof Rack
- Diamond Plate Aluminum Bumper

Running Gear

- (2) 6000# Torsion axles-1 with brake
- 700 x 16" wheels and tires (including spare)
- 10,000# Bulldog 2" coupler
- 1,000# Atwood electric jack
- All DOT required lights
- (2) Rear folding stabilizer jacks

Additional Features

- (2) Outside awning type doors with safety locking gas props on dog cages
- (1) Outside awning type door with safety locking gas props on cat cages
- Coleman MachII 13,500 Roof air conditioner with 5600 BTU heat
- 2 Fantastic Fan Vents installed on Roof
- 5.5KW Onan Generator with built in 20 gallon fuel tank
- Battery charger and 12 volt converter for mobile use
- 25' Shorpower Cord



DEERSKIN MFG. INC.
PO BOX 127 SPRINGTOWN, TEXAS 76082
(800) 880-6089 FAX (817) 523-6685
www.deerskinmfg.com

- 20 gallon fresh water tank and 12 volt water pump
 - Tankless Water Heater
- Mini Refrigerator
- 4-Speakers inside trailer with Bluetooth capability
- 4-Speakers outside trailer with Bluetooth capability

Total Price Per Above Specifications \$ 126,940.00

Quote to
City of Farmers Branch
Ty

Jennifer Villasana
02.13.18

Estimated Completion Date: 14-16 weeks ARO

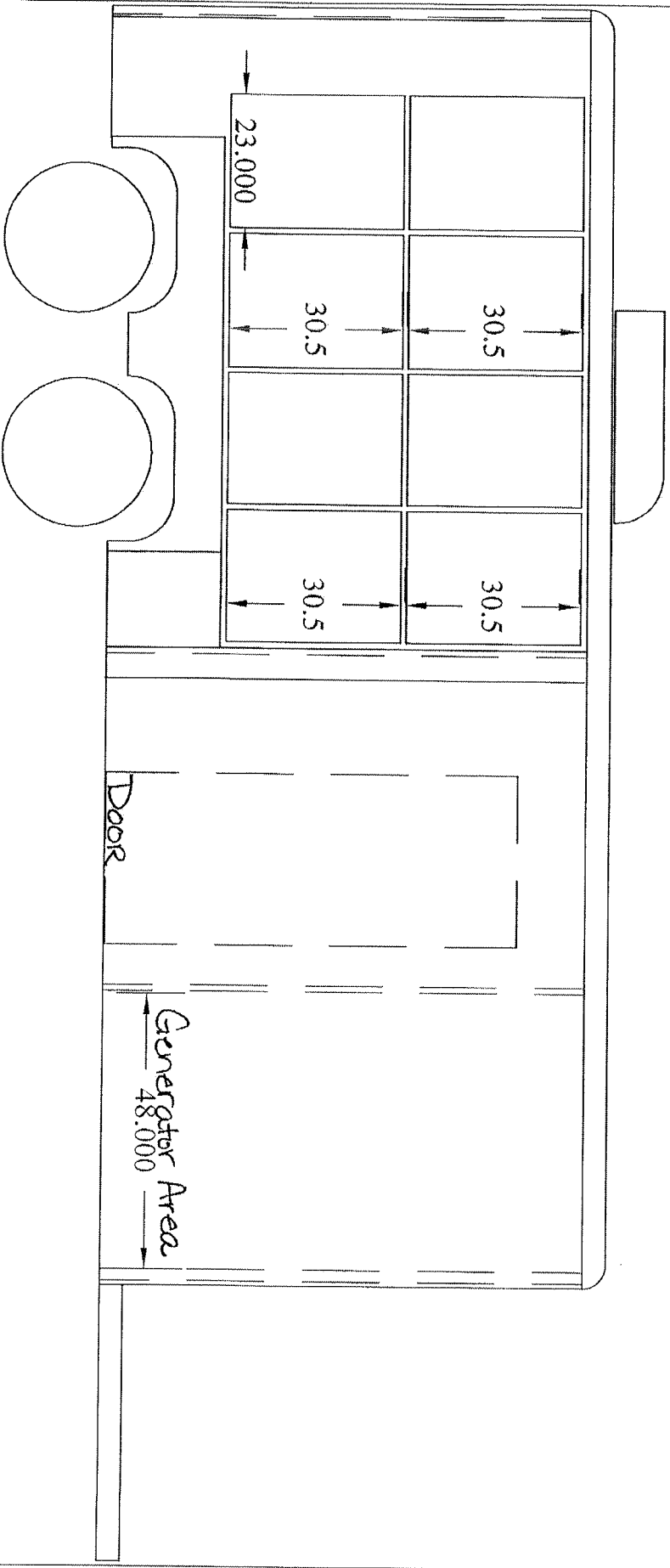

4.375 Round Corner
 2x2 Tubing
 4.000 Channel

Clamps @ 0.000 & 00.000

Deerskin Mfg.

part #

16 Dog/6Cat

Job Title :

Farmers Branch

description :

PS 8 Dog

Material :

xxxxxxxxxxxx

Date :

2018

JVILLASANA

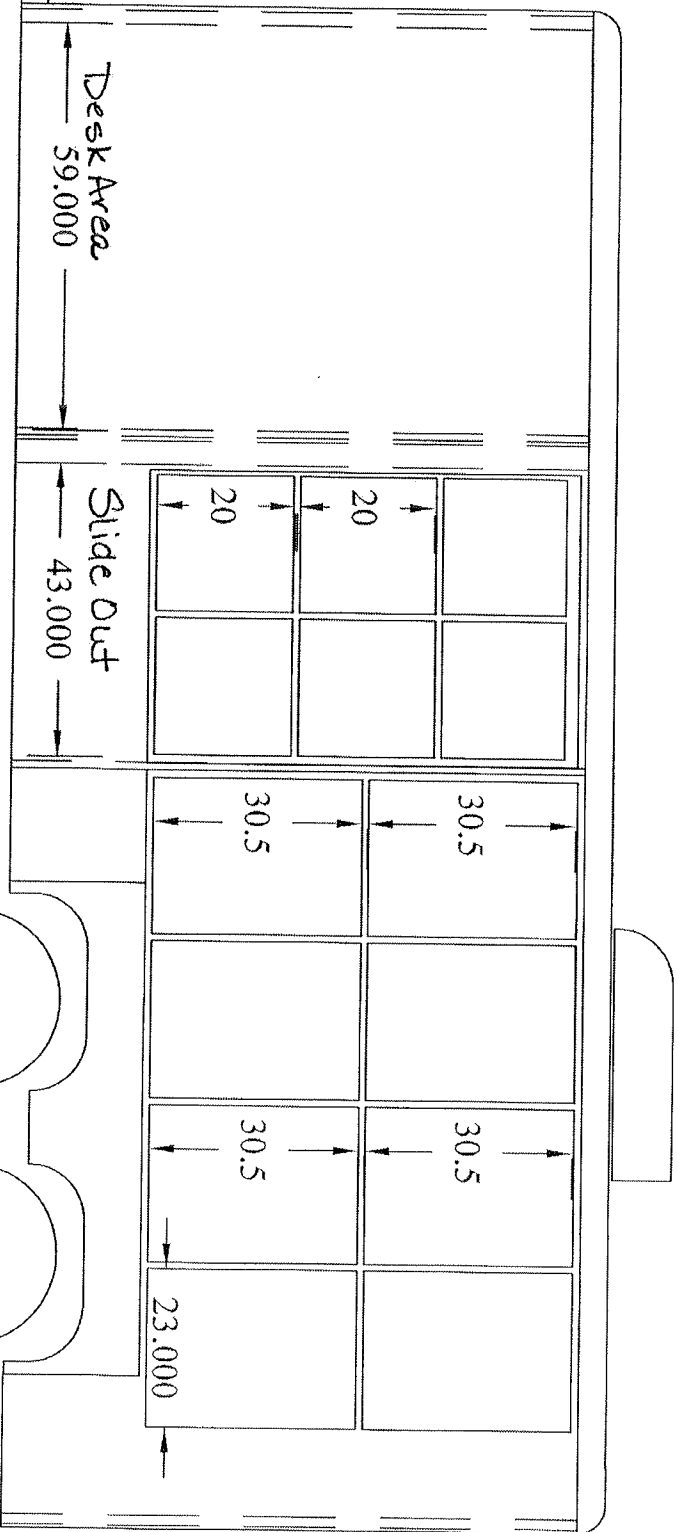

- 4.375 Round Corner
- 2x2 Tubing
- 4.000 Channel

Clamps @ 0.000 & 00.000

Deerskin Mfg.

part #	xxx-xxxx	Job Title :	Farmers Branch
description :	DS 8 Dog/6 Cat	Material :	XXXXXXXXXXXX
Date :	01.30.18		JVILLASANA

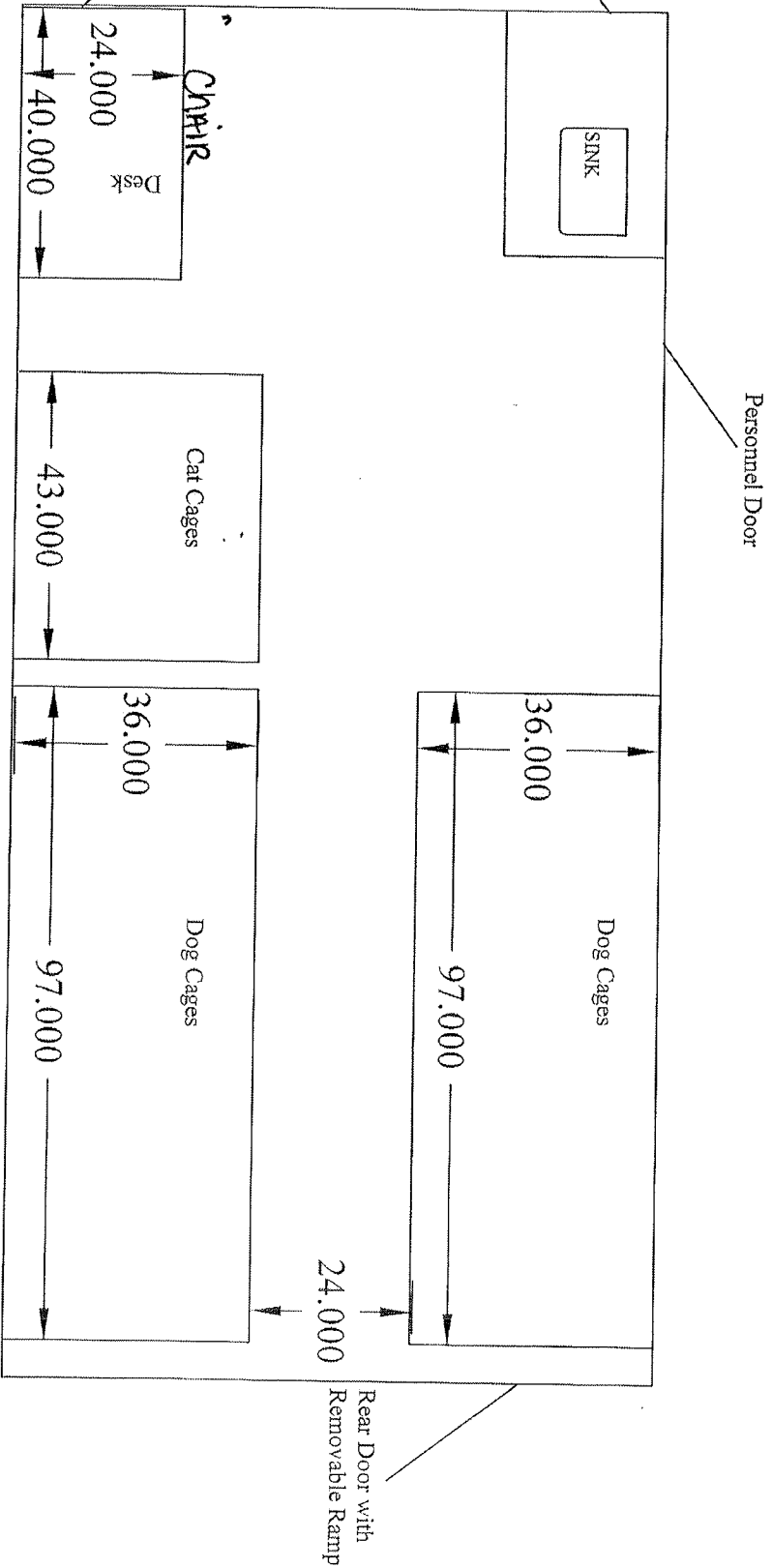

More Room This Design

Qty	Material	Shear Size
X	XXXXXXXXXXXXXXXX	XXXXXXXXXXXXXXXX
X	XXXXXXXXXXXXXXXX	XXXXXXXXXXXXXXXX
X	XXXXXXXXXXXXXXXX	XXXXXXXXXXXXXXXX
X	XXXXXXXXXXXXXXXX	XXXXXXXXXXXXXXXX

Clamps @ 0.000 & 00.000

Deerskin Mfg.

part #	Layout	Job Title:	Farmers Branch
description:	XXXXXXXXXXXXXX	Material:	XXXXXXXXXXXXXX
Date:	02.13.18		JVILLASANA