

Drawing: T:\Projects\2025\2504\Site Plans\Site Plans.dwg at Apr 13, 2025 - 11:10am by jpayne
 Copy: SITE PLAN - BELGRADE.dwg - Z:\BELGRADE.dwg - Z:\LAYOUT.dwg - Z:\UTILITIES.dwg

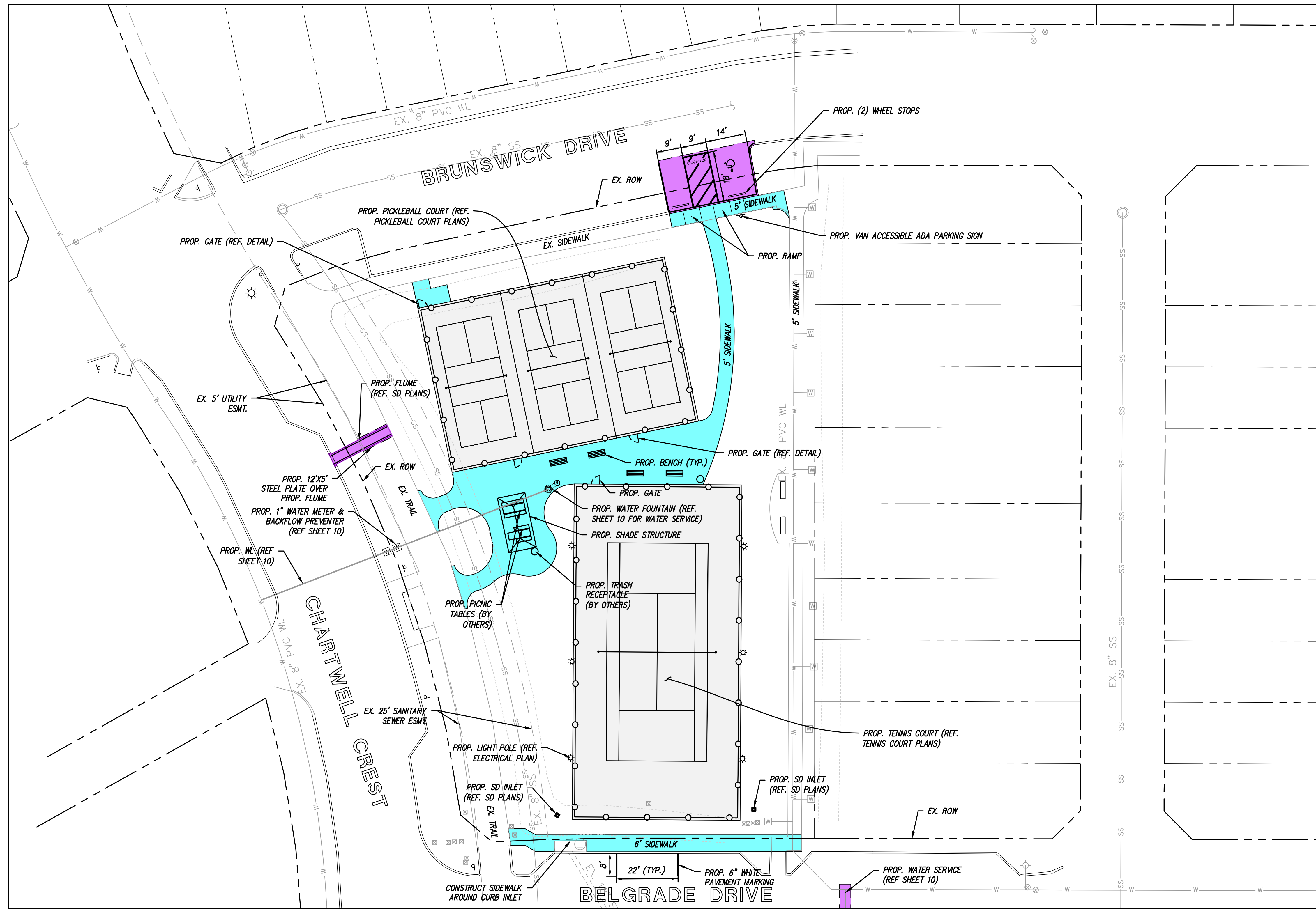

LEGEND	
	PROP CONCRETE PAVEMENT
	PROP CONCRETE FLATWORK
	PROP POUR-IN-PLACE PLAYGROUND SURFACE
	PROP SPORTS COURT (REF. STRUCTURAL PLANS)
	PROP WATER LINE
	PROP SEWER LINE
	PROP FIRE HYDRANT
	PROP WATER VALVE
	EX WATER LINE
	EX FIRE HYDRANT
	EX WATER VALVE
	EX WATER METER
	EX SS LINE
	EX SS MANHOLE
	EX GAS LINE

NOTES:

- ALL BENCHES, PICNIC TABLES, AND TRASH RECEPTACLES WILL BE FURNISHED AND INSTALLED BY THE CITY AND ARE SHOWN ON THIS PLAN FOR REFERENCE ONLY.

MATCHLINE SHEET 06

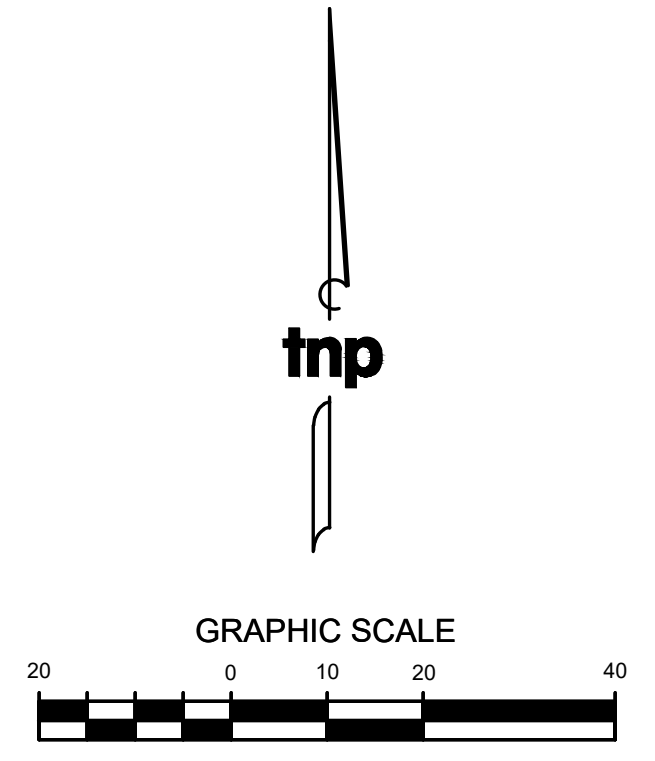

no.	revision	by	date



teague nall and perkins, inc
 825 Waters Creek Blvd., Suite M300
 Allen, Texas 75013
 214.461.9867 ph 214.461.9864 fx
 www.tnppinc.com
 TBPELS: ENGR F-230; SURV 10011600, 10011601, 1019438
 GBPE: PEF007431; TBAE: BR 2673

This document is for interim review and is not intended for construction, bidding or permit purposes.
JONATHAN A. PAYNE, P.E. Date: 04/13/26
 Tx. Reg. # 124784

scale
 when bar is
 1 inch long
 horiz
 1"=20'
 vert
 N/A
 APRIL 2026



City of Farmers Branch, Texas
 Improvements for
MERCER PARK
 SITE PLAN (1 OF 2)

tnp project
FAR23254
 sheet
05

MATCHLINE SHEET 05

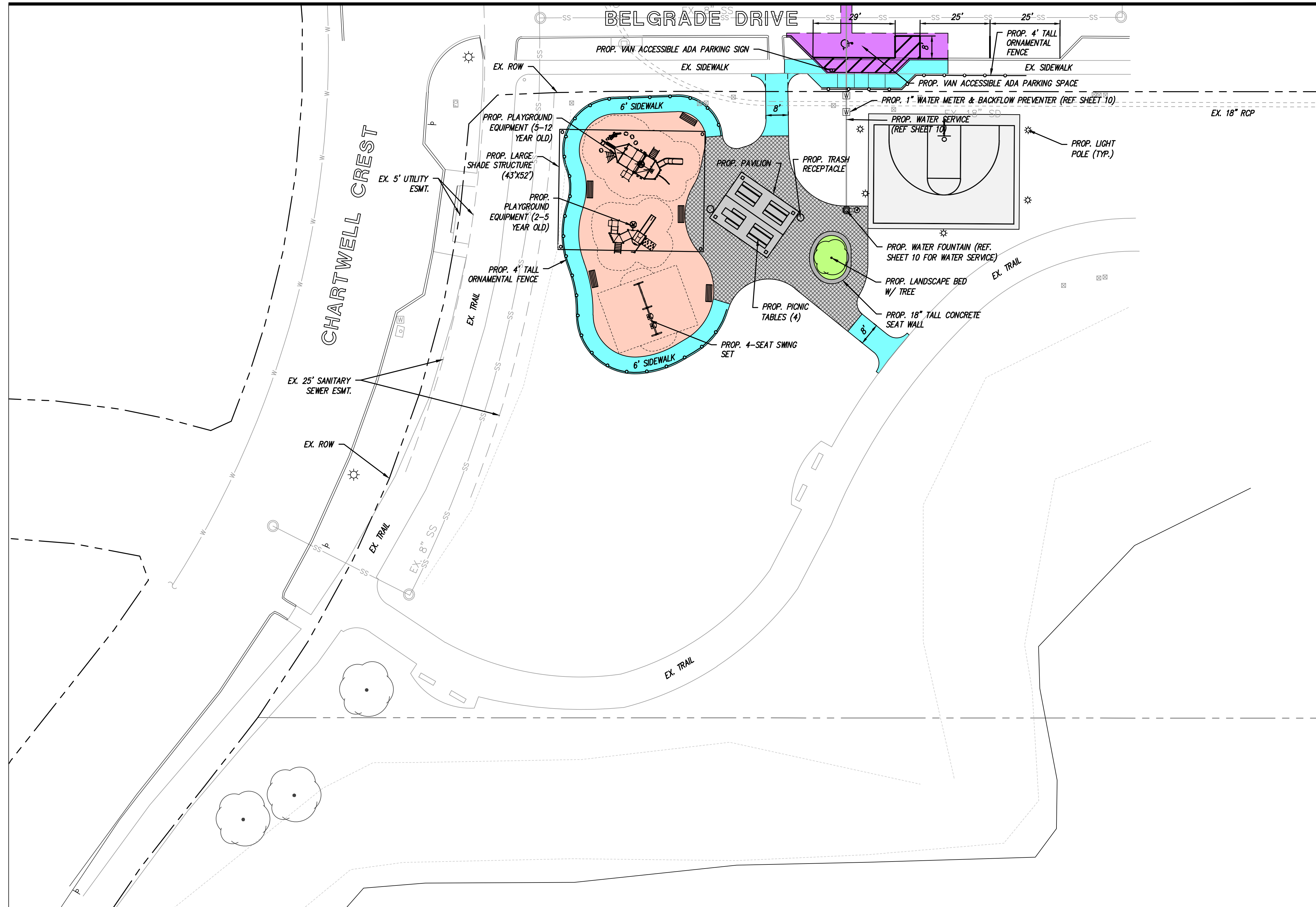

LEGEND	
	PROP CONCRETE PAVEMENT
	PROP CONCRETE FLATWORK
	PROP POUR-IN-PLACE PLAYGROUND SURFACE
	PROP SPORTS COURT (REF. STRUCTURAL PLANS)
	PROP LANDSCAPE BED
	PROP PATTERNED CONCRETE
	PROP WATER LINE
	PROP SEWER LINE
	PROP FIRE HYDRANT
	PROP WATER VALVE
	EX WATER LINE
	EX FIRE HYDRANT
	EX WATER VALVE
	EX WATER METER
	EX SS LINE
	EX SS MANHOLE
	EX GAS LINE

NOTES:
 1. ALL BENCHES, PICNIC TABLES, AND TRASH RECEPTACLES WILL BE FURNISHED AND INSTALLED BY THE CITY AND ARE SHOWN ON THIS PLAN FOR REFERENCE ONLY.

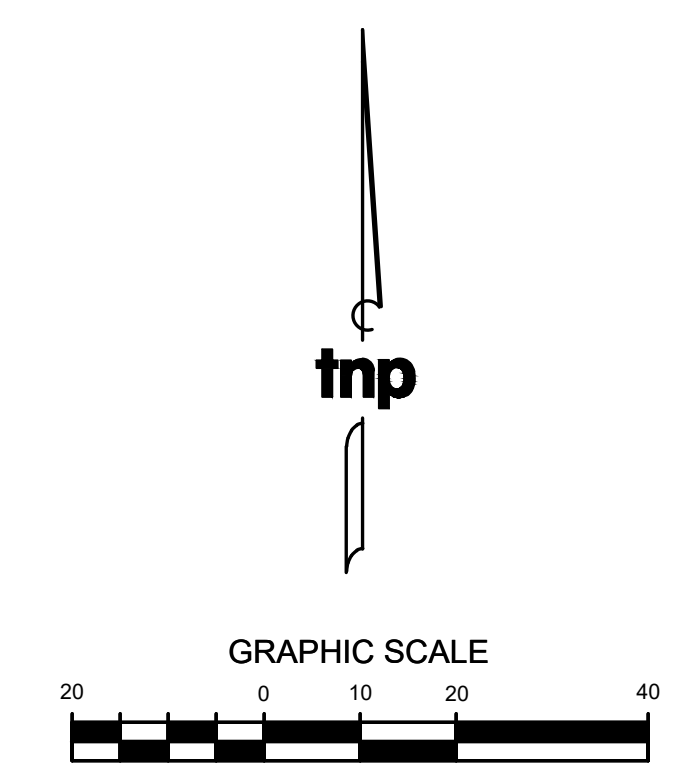

Drawing: T:\Projects\FAR23254\Site Plans\Site Plan.dwg at Apr 13, 2025 11:21am by jpayne
 Copy: SITE PLAN 2 - Area: ZF-BASE.dwg - ZF-BORDER.dwg - ZF-LAYOUT.dwg - ZF-UTILITIES.dwg

no.	revision	by	date



teague nall and perkins, inc
 825 Waters Creek Blvd., Suite M300
 Allen, Texas 75013
 214.461.9867 ph 214.461.9864 fx
 www.tnpsc.com
 TBPES: ENGR F-230; SURV 10011600, 10011601, 1019438
 GBPE: PEF007431; TBAE: BR 2673

This document is for interim review and is not intended for construction, bidding or permit purposes.
JONATHAN A. PAYNE, P.E. Date: 04/13/26
 Tx. Reg. # 124784

scale
 when bar is
 1 inch long
 horiz
 1"=20'
 vert
 N/A
 APRIL 2026



City of Farmers Branch, Texas
 Improvements for
MERCER PARK
 SITE PLAN (2 OF 2)

tnp project
FAR23254
 sheet
06