



# FY2016 DALLAS COUNTY CDBG PROJECT/ACTIVITY APPLICATION



**Due: June 1, 2016 3:30 P.M.**

*Each project/activity must be on a separate application.*

**NAME OF CITY: Farmers Branch**

**TITLE OF PROJECT/ACTIVITY: Shoredale Lane Water Main  
Replacement: From Hollandale Lane to Fyke Road**

- (1.) Number of beneficiaries 970
- (2.) Percentage of beneficiaries being low/moderate income 77.32%
- (3.) How was number of beneficiaries/percentage of beneficiaries being low/moderate income calculated?
  - ☐ by a survey conducted on \_\_\_\_\_
  - ☒ by 2010 census data \_\_\_\_\_
  - ☐ other, explain \_\_\_\_\_
- (4.) Please provide below the required information for the project:
 

Census Tract <u>137.11</u>	Block Group <u>1</u>
Census Tract _____	Block Group _____
Census Tract _____	Block Group _____
Census Tract _____	Block Group _____
- (5.) Identify which national CDBG objective this project addresses:
  - ☒ primarily assists low/moderate income
  - ☐ eradicates blight
  - ☐ eliminates community-threatening condition
  - ☐ N/A (to be used for projects involving ADA accommodations and the elderly which are assumed to automatically address a national objective)

- (6.) Is the service area for this project city-wide?  
[ ] Yes  
[ x ] No If no, a map with the project's service area boundaries clearly marked must be attached. In addition, for capital improvement projects, the map must **clearly** show the location of the project and its beginning and ending points.

- (7.) Describe proposed project: This description should specifically explain what will be undertaken, where it will occur, why it needs to be undertaken, and what problems it will solve. **Please be very specific in the description.** If, for instance, the proposed project involves improving a road or replacing a water line, be sure to state that the project will cover a certain amount of linear feet from Point A to Point B; any problems with the road/line, etc.

The project which has been identified for the FY 2016 CDBG funding is the replacement of approximately 1,350 linear feet of existing water line in Shoredale Lane from Hollandale Lane to Fyke Road. The existing asbestos cement water line is over 33 years old, and is repaired repeatedly. This project will consist of replacement of all the mains, service lines, valves and fire hydrants. Preparation of the plans and specifications would begin later this year with the project being bid and constructed in the second quarter of 2017.

- (8.) Project represents:  
[ x ] new project/activity  
[ ] continuation of an on-going activity such as code enforcement (**please note that all "continuation projects" must have a fully-completed application; please do not use verbiage such as "same as last year" or "refer to previous application"**)  
  
[ ] completion of an existing project, such as a capital improvement project, that has received funding in the past, but still needs additional funding in order to be constructed (**please note that all "completion of existing projects" must have a fully-completed application; please do not use verbiage such as "same as last year" or "refer to previous application"**)

- (9.) Attach a line-item budget for the proposed project/activity. Describe within this budget how proposed costs are derived. **If the project is for a code program, please be sure that the provided budget is for two years.** For capital improvement projects, also provide itemized costs and quantities for such components including, but not limited to, right-of-way/easement acquisition, surveying/engineering design, utility relocation, construction management, materials, and permits/fees. Where possible for capital improvement projects, have the estimates provided by a licensed professional engineer.

- (10.) Describe how project/activity is to be funded:

- FY2016 CDBG funding being allocated \$ 219,773.00
- CDBG funding from completed/canceled projects now being reallocated 0
- Non-CDBG funding that has been allocated \_\_\_\_\_
- Additional funding still needed \_\_\_\_\_

**TOTAL BUDGET: \$ 219,773.00**

- (11.) If carry-over CDBG funding from previous projects is going to be used, identify the previous projects from which this funding is being reallocated and the amounts being reallocated (please note that carryover funds are not available until the project is officially completed and all outstanding invoices have been paid).

N/A

---



---



---

- (12.) If non-CDBG funding is to be used, please describe whether the source of this funding (e.g.--City bond funds, City revenues, state/federal grant, private funding, etc.) has already been secured or when such funding will become available.

N/A

---



---



---

- (13.) If additional funding will still be needed, describe how additional funding will be provided (i.e., through future CDBG funds, city bond program, etc.).

N/A

---



---



---

- (14.) Describe what portions of the project, to the extent applicable, that will be implemented/ managed by the County, the City, another organization, or some combination of these entities.

The City will design, implement, and manage the FY 2016 CDBG project with overview by the County; design of the plans and specifications would begin in the Fall of 2016.

(15.) Proposed start date for implementing project

Preparation of the plans and specifications would begin later in the Fall of 2016, with the project being bid and construction beginning in the second quarter of 2017.

(16.) Proposed completion date

Summer 2017

Contact person for project: Beena Jacob

Title: Sr. Engineering Specialist

Phone number: 972-919-2592

Fax number: 972-919-2585

E-Mail address: beena.jacob@farmersbranchtx.gov

Authorized signature: \_\_\_\_\_  
Bob Phelps, Mayor

# FY 2016 Dallas County Community Development Block Grant Application Project Location for Water Line

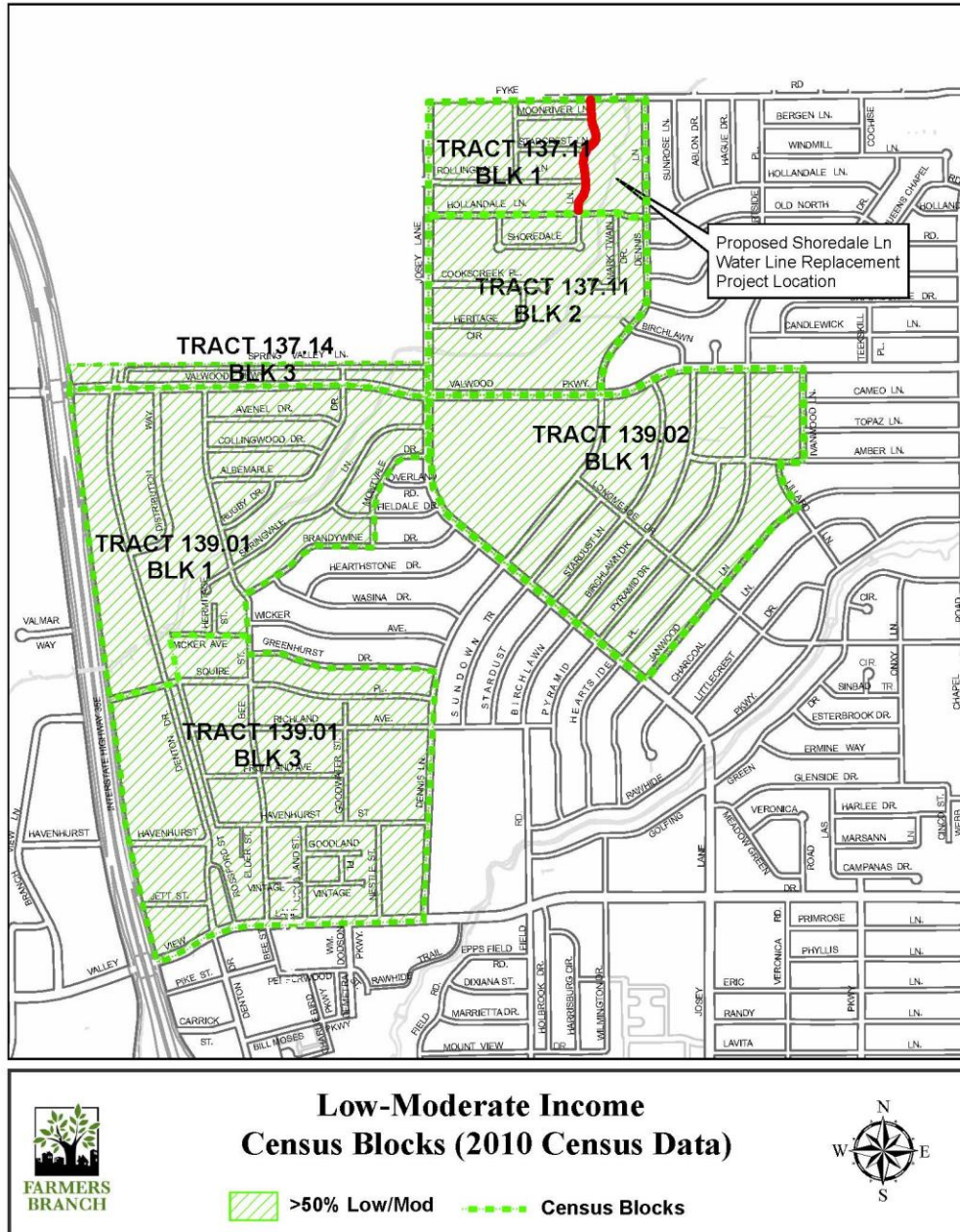

## Cost Estimate: Shoredale Water Line Replacement

PROJECT: CDBG 2016: SHOREDALE LANE WATER LINE				Engineer's Estimate	
Item	Description	Bid Qty		Unit Price	Total
SHOREDALE WATER LINE REPLACEMENT					
1	SAWCUT FULL DEPTH AND REMOVE EXISTING PAVEMENT	SY	1,350	\$15.00	\$20,250.00
3	CONSTRUCT 3" THICK TYPE 'D' HMAC PAVEMENT	SY	750	\$40.00	\$30,000.00
4	TURF ESTABLISHMENT-SOLID SOD, INCLUDING 2" TOPSOIL	SY	70	\$16.00	\$1,120.00
5	FURNISH & INSTALL 8" C-900 PVC DR-14 WATERLINE BY OPEN CUT INCLUDING CONNECTIONS, FITTINGS, EMBEDMENT & BACKFILL	LF	1,350	\$46.00	\$62,100.00
6	FURNISH & INSTALL 6" C-900 PVC DR-14 FIRE HYDRANT LEAD BY OPEN CUT INCLUDING CONNECTIONS, FITTINGS, EMBEDMENT & BACKFILL	LF	100	\$30.00	\$3,000.00
7	FIRNISH & INSTALL 8"x12" TAPPING SLEEVE & 8" VALVE	EA	2	\$5,200.00	\$10,400.00
8	FURNISH & INSTALL 8" GATE VALVE	EA	3	\$1,200.00	\$3,600.00
9	FURNISH & INSTALL 6" GATE VALVE	EA	3	\$1,000.00	\$3,000.00
11	FURNISH & INSTALL 1" TYPE 'K' COPPER WATER SERVICE (LONG), REMOVE & REPLACE EXISTING METER W 3/4" AMR, METER & NEW METER BOX	EA	14	\$1,500.00	\$21,000.00
12	FURNISH & INSTALL NEW FIRE HYDRANT	EA	3	\$3,000.00	\$9,000.00
13	TRAFFIC CONTROL PLAN & IMPLEMENTATION (WATER)	LS	1	\$1,500.00	\$1,500.00
14	TRENCH SAFETY DESIGN & IMPLEMENTATION	LF	1,350	\$0.50	\$675.00
15	EROSION CONTROL PLANS & IMPLEMENTATION	LS	1	\$1,000.00	\$1,000.00
16	2" THICK TEMPORARY ASPHALT	SY	100	\$14.00	\$1,400.00
SHOREDALE WATER MAIN REPLACEMENT: FYKE TO HOLLANDALE:				\$168,045.00	



**Shoredale Street View Looking North From Starcrest &  
Water Main Breaks Data on Shoredale From 2011 to March 2016**



[Home](#) » [Active Projects](#) » [Advance Search](#) » [Search Results](#)

## Your Search Results

The results of your search are listed in the table below.

[Change Search Criteria](#)

Pre - Warning Over - Warning

&lt;&lt; prev

Showing Results 41 - 60 of 65

next &gt;&gt;

id #	start date	category	subcategory	address	status	days	cost	updates
13-02875	Oct 8, 2013	Utilities	SSO Cleaning Program	shoredale	Completed	0d 0h	\$ 119.16	1 (view)
13-03391	Nov 27, 2013	Utilities	Sewer Calls	14311 Shoredale	Completed	1d 6h	\$ 98.98	1 (view)
14-00498	Feb 13, 2014	Utilities	Sewer Calls	14310 shoredale	Completed	0d 0h	\$ 402.40	1 (view)
14-00601	Feb 24, 2014	Utilities	Sewer Calls	14330 Shoredale	Completed	0d 0h	\$ 59.58	1 (view)
14-01211	Apr 21, 2014	Utilities	Reconnects / Disconnects	14242 Shoredale	Completed	0d 0h	\$ 20.08	1 (view)
14-02201	Aug 4, 2014	Utilities	Water Leaks	14404 Shoredale	Completed	68d 8h	\$ 820.79	1 (view)
14-02305	Aug 13, 2014	Utilities	Meter Replacement	14323 Shoredale	Completed	0d 0h	\$ 138.95	1 (view)
14-02347	Aug 18, 2014	Utilities	Meter Reports	14310 shoredale	Completed	5d 23h	\$ 130.12	1 (view)
14-03053	Oct 15, 2014	Utilities	Meter Replacement	14270 SHOREDALE Ln.	Completed	15d 4h	\$ 140.50	1 (view)
14-03385	Nov 11, 2014	Utilities	Meter Replacement	14260 shoredale Ln.	Completed	2d 2h	\$ 120.75	3 (view)
15-00013	Jan 3, 2015	Utilities	Sewer Calls	14330 Shoredale	Completed	0d 1h	\$ 63.48	1 (view)
15-01734	May 30, 2015	Utilities	Sewer Calls	14330 Shoredale	Completed	1d 9h	\$ 27.97	1 (view)
15-02510	Aug 9, 2015	Utilities	Water Main Break	14505 Shoredale	Completed	23d 15h	\$ 4,694.19	5 (view)
15-03625	Nov 24, 2015	Utilities	SSO Cleaning Program	shoredale	Completed	0d 0h	\$ 208.53	1 (view)
15-03628	Nov 24, 2015	Utilities	SSO Sewer Inspection	shoredale	Completed	0d 0h	\$ 133.77	1 (view)
15-03761	Dec 3, 2015	Utilities	SSO Sewer Inspection	shoredale	Completed	0d 0h	\$ 85.36	1 (view)
15-03886	Dec 11, 2015	Utilities	SSO Sewer Inspection	shoredale	Completed	0d 0h	\$ 222.95	1 (view)
15-03890	Dec 11, 2015	Utilities	SSO Cleaning Program	shoredale	Completed	0d 0h	\$ 175.95	1 (view)
15-03918	Dec 14, 2015	Utilities	SSO Sewer Inspection	shoredale	Completed	0d 0h	\$ 58.18	1 (view)
15-03932	Dec 15, 2015	Utilities	SSO Cleaning Program	shoredale	Completed	0d 0h	\$ 151.16	1 (view)

&lt;&lt; prev

next &gt;&gt;

[Back](#)



[Home](#) » [Active Projects](#) » [Advance Search](#) » [Search Results](#)

## Your Search Results

The results of your search are listed in the table below.

► [Change Search Criteria](#)

Pre - Warning Over - Warning

<< prev

Showing Results 21 - 40 of 65

next >>

id #	start date	category	subcategory	address	status	days	cost	updates	
12-01281	May 8, 2012	Utilities	SSO Manhole Inspection	14232 Shoredale	Completed	5d 0h	\$ 379.80	1	(view)
12-01282	May 8, 2012	Utilities	SSO Manhole Inspection	14260 Shoredale	Completed	5d 0h	\$ 379.80	1	(view)
12-01313	May 16, 2012	Utilities	Reconnects / Disconnects	14242 Shoredale	Completed	0d 0h	\$ 9.31	1	(view)
12-01414	May 31, 2012	Utilities	Reconnects / Disconnects	14510 Shoredale	Completed	0d 0h	\$ 101.33	1	(view)
12-02145	Jul 12, 2012	Utilities	SSO Manhole Inspection	14530 Shoredale	Completed	22d 0h	\$ 759.60	2	(view)
12-02146	Jul 12, 2012	Utilities	SSO Manhole Inspection	14506 Shoredale	Completed	22d 0h	\$ 379.80	1	(view)
12-02147	Jul 12, 2012	Utilities	SSO Manhole Inspection	14424 Shoredale	Completed	22d 0h	\$		
12-02040	Aug 6, 2012	Utilities	Water Main Break	14216 Shoredale	Completed	31d 7h	\$ 1		
12-02165	Aug 14, 2012	Utilities	Meter Reports	14434 Shoredale	Completed	89d 23h	\$ 254.75	1	(view)
12-02577	Sep 17, 2012	Utilities	Water Main Break	14429 Shoredale	Completed	0d 17h	\$ 1,507.44	2	(view)
12-02911	Oct 17, 2012	Utilities	Reconnects / Disconnects	14330 Shoredale	Completed	0d 0h	\$ 18.09	1	(view)
12-03339	Dec 4, 2012	Utilities	Miscellaneous	Shoredale	Completed	0d 0h	\$ 162.06	1	(view)
12-03438	Dec 14, 2012	Utilities	Water Main Break	14506 Shoredale	Completed	35d 1h	\$ 1,331.78	1	(view)
13-00139	Jan 17, 2013	Utilities	Reconnects / Disconnects	14424 Shoredale	Completed	0d 0h	\$ 38.36	1	(view)
13-00140	Jan 17, 2013	Utilities	Reconnects / Disconnects	14414 Shoredale	Completed	0d 0h	\$ 38.36	1	(view)
13-00332	Jan 30, 2013	Utilities	Sewer Calls	14333 Shoredale	Completed	2d 21h	\$ 251.07	1	(view)
13-00378	Feb 6, 2013	Utilities	Reconnects / Disconnects	14405 Shoredale	Completed	0d 0h	\$ 18.63	1	(view)
13-01456	May 21, 2013	Utilities	Meter Reports	14444 Shoredale	Completed	0d 0h	\$ 39.16	1	(view)
13-01957	Jul 9, 2013	Utilities	Water Leaks	14202 Shoredale	Completed	0d 0h	\$ 39.25	1	(view)
13-02345	Aug 17, 2013	Utilities	Sewer Calls	14333 Shoredale	Completed	1d 0h	\$ 75.31	1	(view)

<< prev

next >>

[Back](#)

[Home](#) » [Active Projects](#) » [Advance Search](#) » [Search Results](#)

## Your Search Results

The results of your search are listed in the table below.

► [Change Search Criteria](#)

Pre - Warning Over - Warning

Showing Results 1 - 20 of 65

[next >>](#)

id #	start date	category	subcategory	address	status	days	cost	updates	
09-01147	Nov 5, 2009	Utilities	Sewer Calls	14311 SHOREDALE	Completed	3d 0h	\$ 77.90	1	(view)
09-01107	Nov 5, 2009	Utilities	Sewer Calls	14311 shoredale	Completed	1d 0h	\$ 76.35	1	(view)
10-00258	Jan 15, 2010	Utilities	Reconnects / Disconnects	14254 Shoredale	Completed	0d 15h	\$ 35.85	1	(view)
10-01121	Apr 7, 2010	Utilities	Meter Reports	14444 SHOREDALE	Completed	6d 2h	\$ 194.48	1	(view)
10-02049	Jul 21, 2010	Utilities	Meter Reports	14414 Shoredale	Completed	61d 17h	\$ 557.74	1	(view)
10-03253	Dec 29, 2010	Utilities	Meter Reports	14304 SHOREDALE	Completed	11d 2h	\$ 143.74	1	(view)
11-00205	Jan 19, 2011	Utilities	Reconnects / Disconnects	14405 Shoredale	Completed	0d 0h	\$ 20.08	1	(view)
11-01368	Apr 22, 2011	Utilities	Sewer Calls	14440 Shoredale	Completed	0d 13h	\$ 103.28	1	(view)
11-01497	Apr 25, 2011	Utilities	Miscellaneous	14440 SHOREDALE	Completed	11d 0h	\$ 151.92	1	(view)
11-01376	Apr 25, 2011	Utilities	SSO Sewer Inspection	14440 Shoredale	Completed	2d 21h	\$ 216.66	1	(view)
11-01398	Apr 27, 2011	Utilities	SSO Sewer Inspection	14440 Shoredale	Completed	0d 0h	\$ 290.07	1	(view)
11-01836	Jun 8, 2011	Utilities	Meter Reports	14524 SHOREDALE	Completed	3d 20h	\$ 40.97	1	(view)
11-01837	Jun 8, 2011	Utilities	Meter Reports	14520 SHOREDALE	Completed	3d 20h	\$ 40.97	1	(view)
11-01838	Jun 8, 2011	Utilities	Meter Reports	14514 SHOREDALE	Completed	3d 20h	\$ 278.08	1	(view)
11-01958	Jun 18, 2011	Utilities	Reconnects / Disconnects	13243 Shoredale	Completed	0d 9h	\$ 51.64	1	(view)
11-03366	Oct 21, 2011	Utilities	Water Leaks	Starcrest & Shoredale	Completed	18d 7h	\$ 749.41	3	(view)
12-00426	Feb 13, 2012	Utilities	Meter Reports	14246 shoredale Ln.	Completed	44d 21h	\$ 139.10	1	(view)
12-00953	Apr 10, 2012	Utilities	Water Leaks	14237 Shoredale	Completed	9d 1h	\$ 1,804.81	4	(view)
12-01178	May 6, 2012	Utilities	Miscellaneous	14222 Shoredale	Completed	0d 11h	\$ 75.31	1	(view)
12-01193	May 7, 2012	Utilities	Meter Reports	14266 Shoredale	Completed	0d 0h	\$ 123.93	1	(view)

[next >>](#)



# **FY2016 DALLAS COUNTY CDBG PROJECT/ACTIVITY APPLICATION**



**Due: June 1, 2016 3:30 P.M.**

*Each project/activity must be on a separate application.*

**NAME OF CITY: Farmers Branch**

**TITLE OF PROJECT/ACTIVITY: Shoredale Lane Sewer Main Replacement: From Hollandale Lane to Fyke Road**

- (1.) Number of beneficiaries 970
- (2.) Percentage of beneficiaries being low/moderate income 77.32%
- (3.) How was number of beneficiaries/percentage of beneficiaries being low/moderate income calculated?
  - ☐ by a survey conducted on \_\_\_\_\_
  - ☒ by 2010 census data \_\_\_\_\_
  - ☐ other, explain \_\_\_\_\_
- (4.) Please provide below the required information for the project:
 

Census Tract <u>137.11</u>	Block Group <u>1</u>
Census Tract _____	Block Group _____
Census Tract _____	Block Group _____
Census Tract _____	Block Group _____
- (5.) Identify which national CDBG objective this project addresses:
  - ☒ primarily assists low/moderate income
  - ☐ eradicates blight
  - ☐ eliminates community-threatening condition
  - ☐ N/A (to be used for projects involving ADA accommodations and the elderly which are assumed to automatically address a national objective)

- (6.) Is the service area for this project city-wide?  
[ ] Yes  
[ x ] No If no, a map with the project's service area boundaries clearly marked must be attached. In addition, for capital improvement projects, the map must **clearly** show the location of the project and its beginning and ending points.
- (7.) Describe proposed project: This description should specifically explain what will be undertaken, where it will occur, why it needs to be undertaken, and what problems it will solve. **Please be very specific in the description.** If, for instance, the proposed project involves improving a road or replacing a water line, be sure to state that the project will cover a certain amount of linear feet from Point A to Point B; any problems with the road/line, etc.

The project which has been identified for the FY 2016 CDBG funding is the replacement of approximately 327 linear feet of existing sanitary sewer line in Shoredale Lane from Rollingdale Lane to 27 feet north of Starcrest Lane. The existing clay sewer line is over 49 years old and is broken. This project will consist of replacement of all the mains, service lines, and manholes. Preparation of the plans and specifications would begin later this year with the project being bid and constructed in the second quarter of 2017.

- (8.) Project represents:  
[ x ] new project/activity  
[ ] continuation of an on-going activity such as code enforcement **(please note that all "continuation projects" must have a fully-completed application; please do not use verbiage such as "same as last year" or "refer to previous application")**
- [ ] completion of an existing project, such as a capital improvement project, that has received funding in the past, but still needs additional funding in order to be constructed **(please note that all "completion of existing projects" must have a fully-completed application; please do not use verbiage such as "same as last year" or "refer to previous application")**
- (9.) Attach a line-item budget for the proposed project/activity. Describe within this budget how proposed costs are derived. **If the project is for a code program, please be sure that the provided budget is for two years.** For capital improvement projects, also provide itemized costs and quantities for such components including, but not limited to, right-of-way/easement acquisition, surveying/engineering design, utility relocation, construction management, materials, and permits/fees. Where possible

for capital improvement projects, have the estimates provided by a licensed professional engineer.

(10.) Describe how project/activity is to be funded:

- |   |                      |
|---|----------------------|
| • FY2016 CDBG funding being allocated                                 | \$ <u>219,773.00</u> |
| • CDBG funding from completed/canceled projects now being reallocated | <u>0</u>             |
| • Non-CDBG funding that has been allocated                            | <u>          </u>    |
| • Additional funding still needed                                     | <u>          </u>    |

**TOTAL BUDGET: \$ 219,773.00**

(11.) If carry-over CDBG funding from previous projects is going to be used, identify the previous projects from which this funding is being reallocated and the amounts being reallocated (please note that carryover funds are not available until the project is officially completed and all outstanding invoices have been paid).

N/A

---

---

(12.) If non-CDBG funding is to be used, please describe whether the source of this funding (e.g.--City bond funds, City revenues, state/federal grant, private funding, etc.) has already been secured or when such funding will become available.

N/A

---

(13.) If additional funding will still be needed, describe how additional funding will be provided (i.e., through future CDBG funds, city bond program, etc.).

N/A

---

- (14.) Describe what portions of the project, to the extent applicable, that will be implemented/ managed by the County, the City, another organization, or some combination of these entities.

The City will design, implement, and manage the FY 2016 CDBG project with overview by the County; design of the plans and specifications would begin in the Fall of 2016.

- (15.) Proposed start date for implementing project

Preparation of the plans and specifications would begin later in the Fall of 2016, with the project being bid and construction beginning in the second quarter of 2017.

- (16.) Proposed completion date

Summer 2017

Contact person for project: Beena Jacob

Title: Sr. Engineering Specialist

Phone number: 972-919-2592

Fax number: 972-919-2585

E-Mail address: beena.jacob@farmersbranchtx.gov

Authorized signature: \_\_\_\_\_  
Bob Phelps, Mayor



# FY 2016 Dallas County Community Development Block Grant Application Project Location for Sewer Line

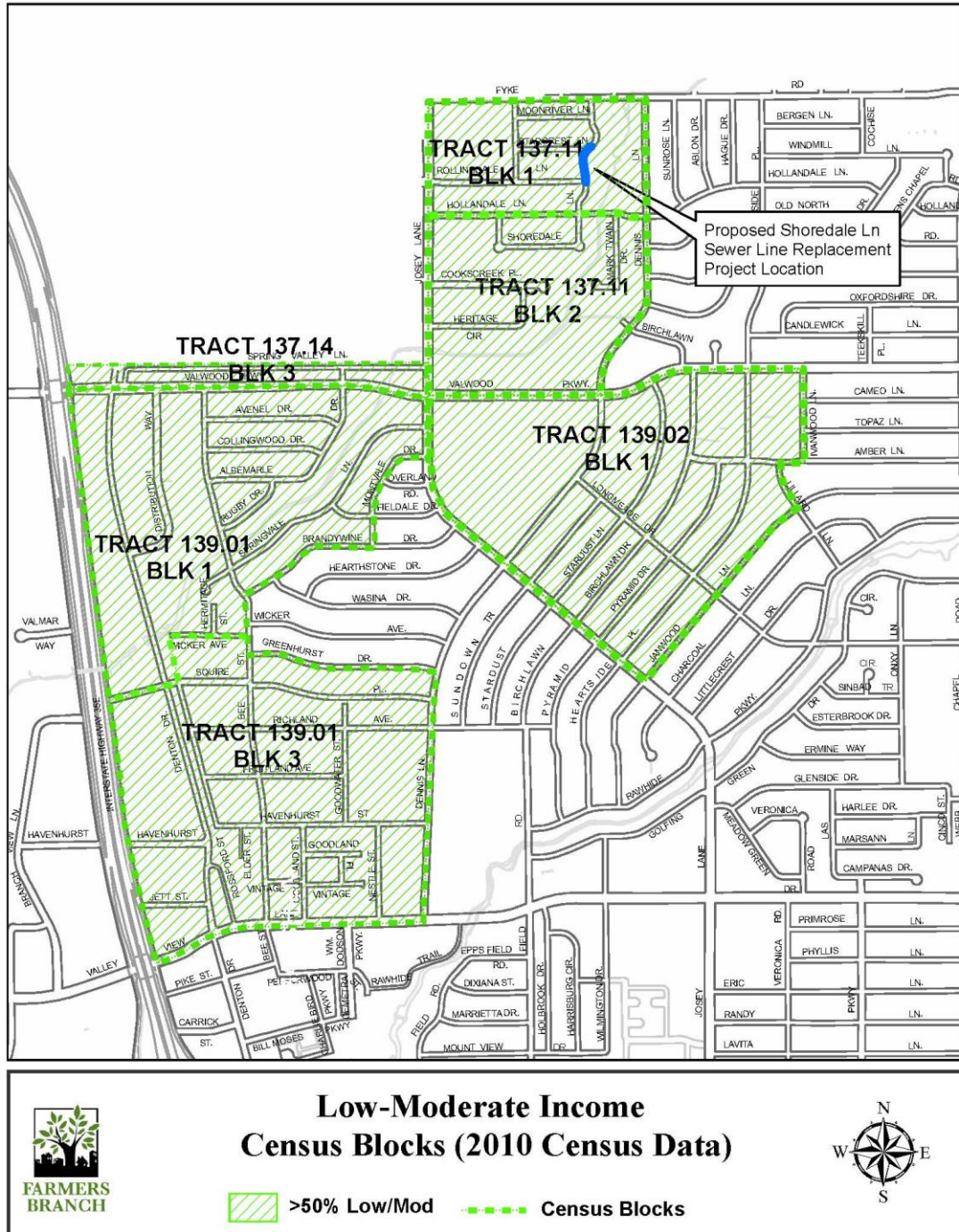

## Cost Estimate: Shoredale Sewer Line Replacement

SHOREDALE SEWER LINE REPLACEMENT					
1	REPLACE EX. 8" SAN. SEWER W/ 8" SDR-21 HDPE SAN. SEWER BY PIPE BURSTING, INCLUDING REMOVAL OF EXIST. MH & CLEANOUT, CONNECTIONS	LF	327	\$70.00	\$22,890.00
2	4" SCHEDULE 40 SERVICE LINE W/ CLEANOUT BY OPEN CUT	EA	8	\$800.00	\$6,400.00
3	4.0' DIAMETER MANHOLE	EA	2	\$7,500.00	\$15,000.00
6	FURNISH & INSTALL 3" THICK TYPE D HMA AS APPROVED BY THE ENGINEER	SY	180	\$36.00	\$6,480.00
7	TRENCH SAFETY DESIGN & IMPLEMENTATION	LF	327	\$1.00	\$327.00
8	EROSION CONTROL PLANS & IMPLEMENTATION	LS	1	\$500.00	\$500.00
SHOREDALE SEWER REPLACEMENT: ROLLINGDALE TO 27' N. OF STARDUST:					\$51,597.00





**Shoredale Street View**



**Inside of the Shoredle Clay Sewer Pipe**



**Inside of the Shoredale Clay Sewer Pipe**



**Inside of the Shoredale Clay Sewer Pipe**