



FARMERS
BRANCH

2019 Valley View Ln

Municipal Settings Designation



Municipal Settings Background

- An MSD - a state designation given by TCEQ to property within a municipality that certifies that groundwater at the property is not used as potable water, and is **prohibited from future use** as potable water.
- Prohibition is in the form of a City ordinance
- TCEQ is the permitting authority; local support is mandatory
- Application Eligibility
 - Property within the local government jurisdiction
 - Jurisdiction has a public water supply system that meets State requirements, and
 - Water supply system is capable of providing drinking water to MSD property

Permitting Process



MUNICIPAL SETTING DESIGNATION (MSD) 2019 VALLEY VIEW LANE FARMERS BRANCH, TEXAS



MSD PROPERTY INVESTIGATION RESULTS

13 permanent groundwater monitoring wells installed.

Groundwater samples, surface soil samples, and subsurface soil samples collected.

Analyses of samples for volatile organic compounds (VOCs) and metals .

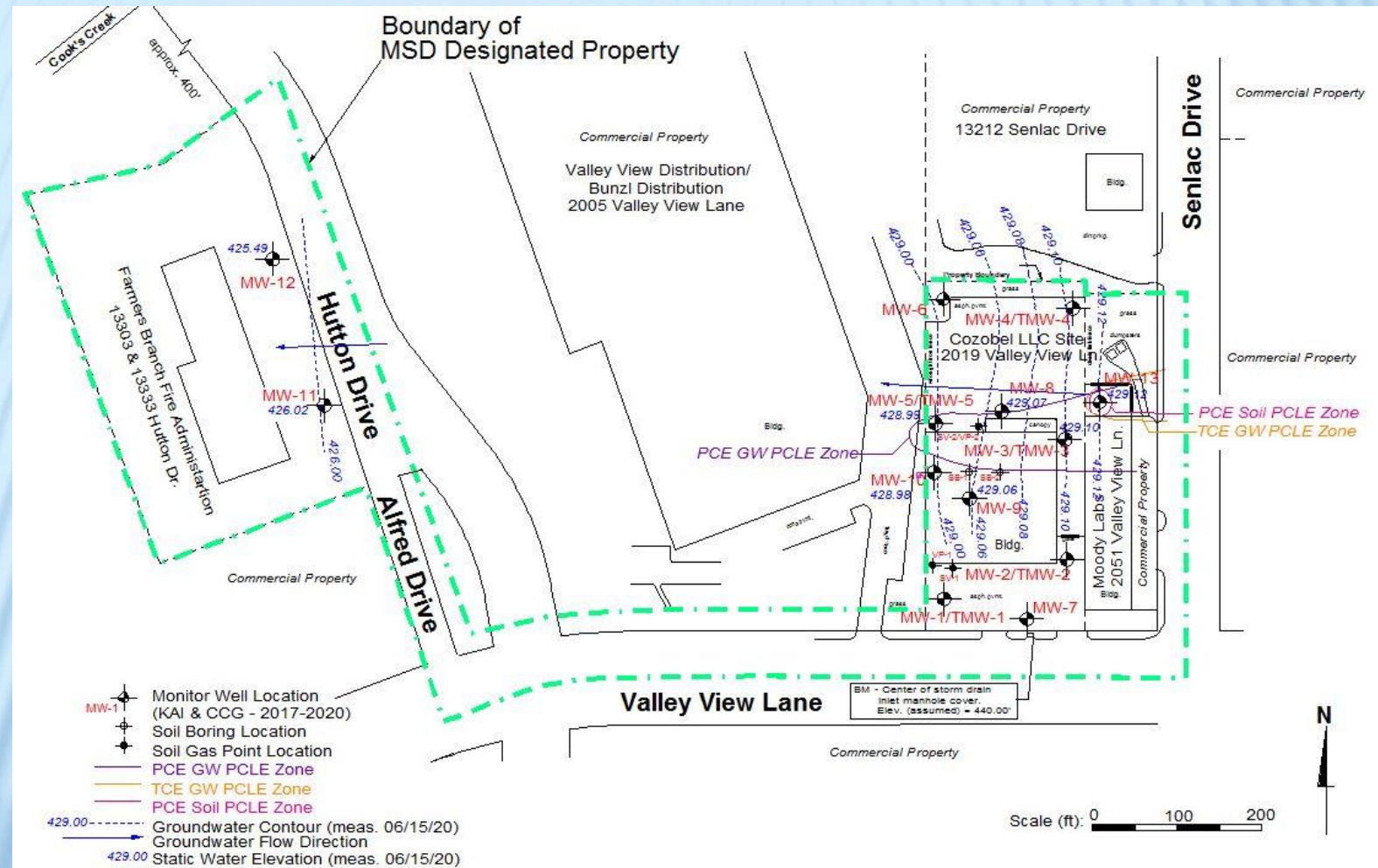

GROUNDWATER INVESTIGATION RESULTS - PCE

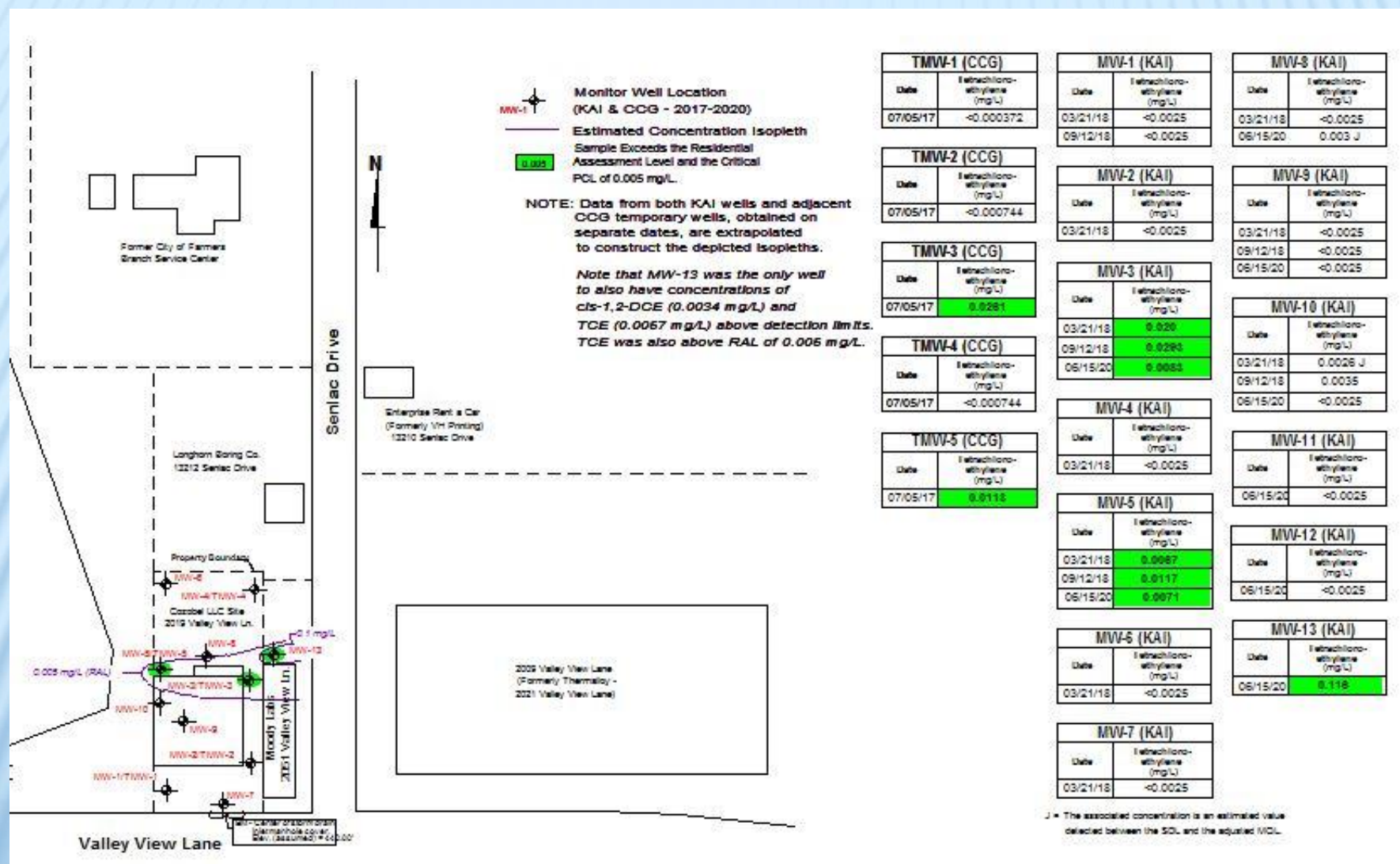

Chlorinated solvent PCE detected in groundwater above Critical PCL in three monitoring wells.

GROUNDWATER INVESTIGATION RESULTS - TCE

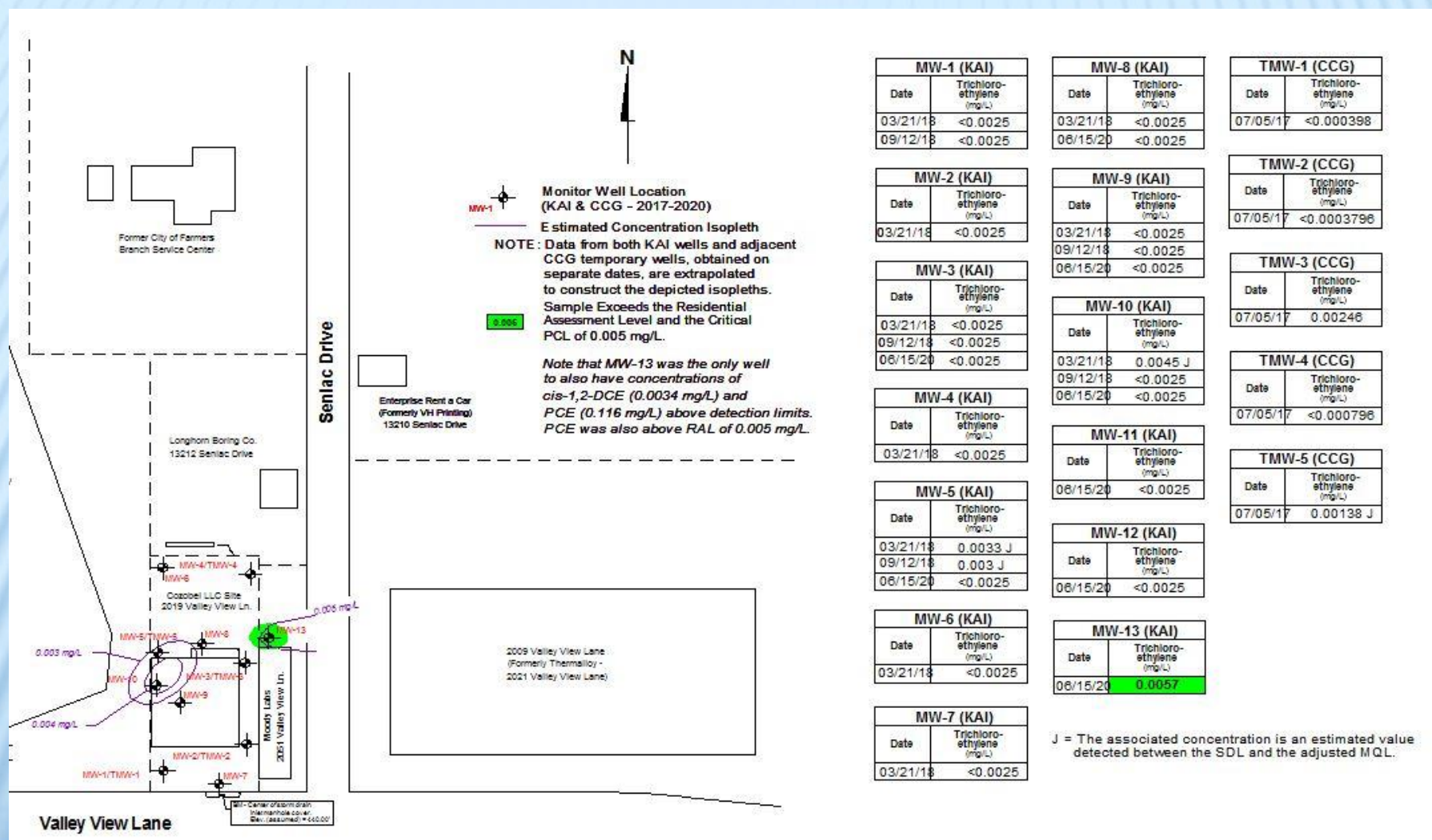

Chlorinated solvent TCE detected in groundwater above Critical PCL in one monitoring well.

Chlorinated solvent PCE detected in soil above Critical PCL in one well: off-site upgradient MW-13. No metals above Critical PCLs.



MSD DESIGNATED PROPERTY

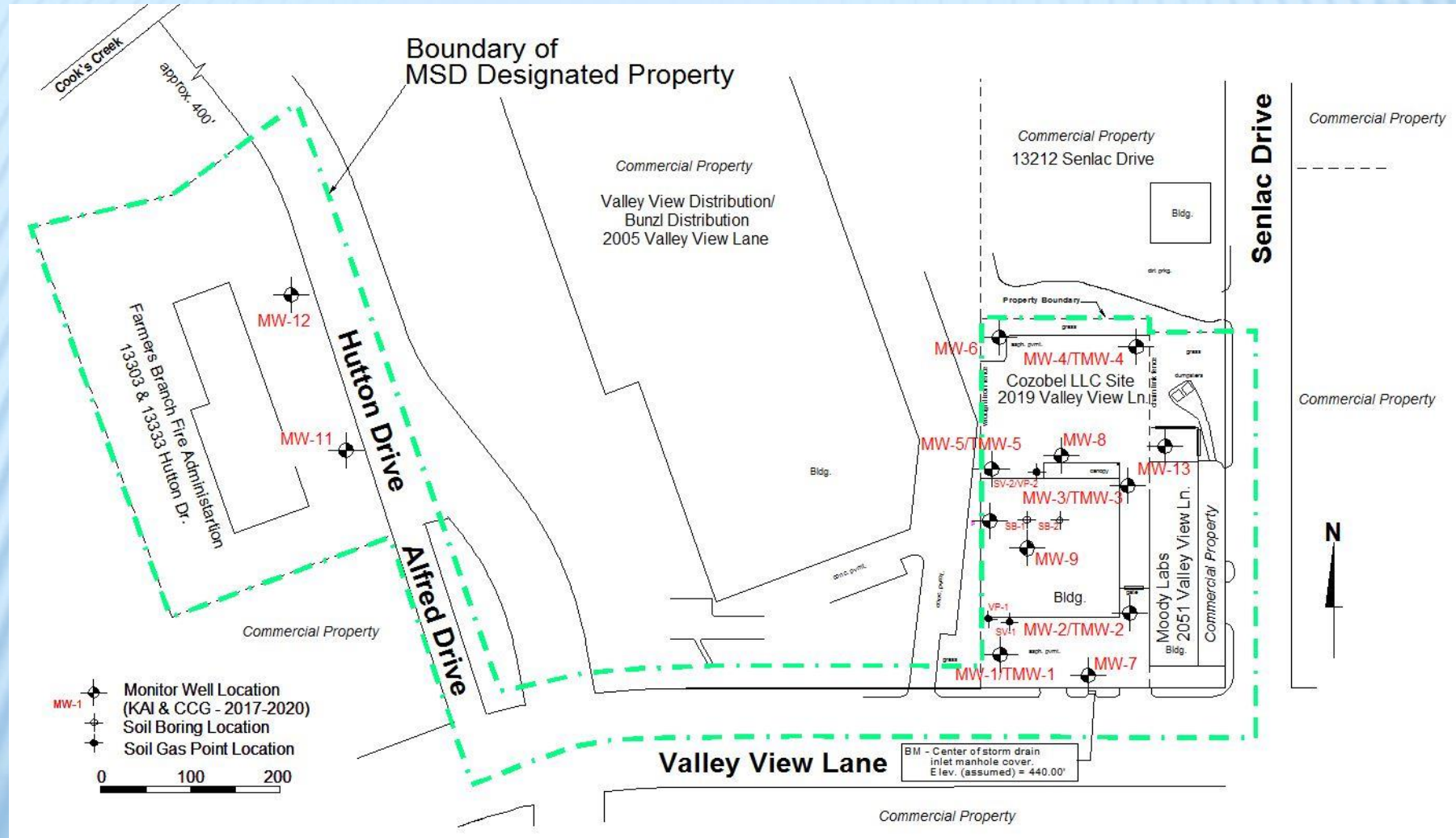

A decorative graphic on the left side of the slide featuring stylized blue leaves of various shapes and sizes, arranged along a diagonal branch. The background is a solid dark blue, with a light blue horizontal bar at the top and a light green horizontal bar at the bottom.

DISCUSSION