

EZOELLNER
9/7/2021 3:21 PM
M:\DWG-27\2720-20.274\DWG\CIVIL C3D 2018\2720-20.274 SITE PLAN.DWG

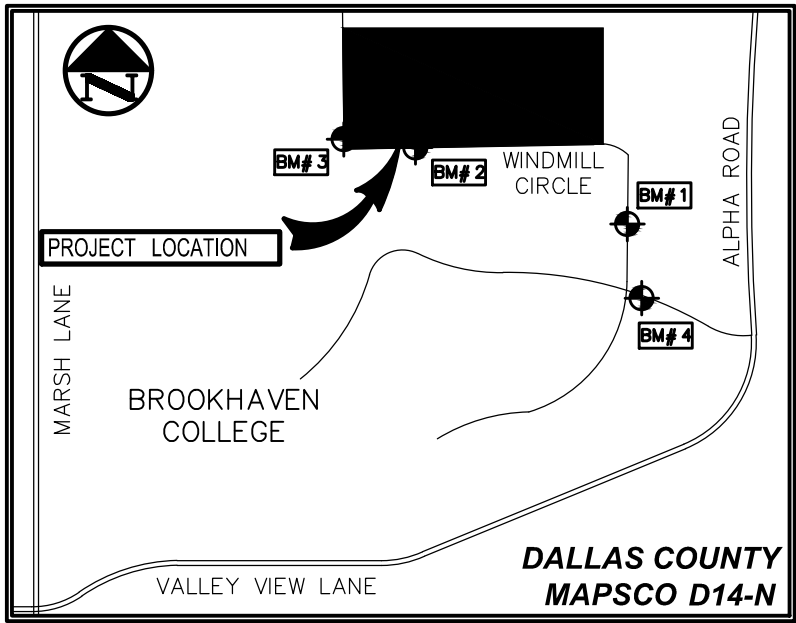
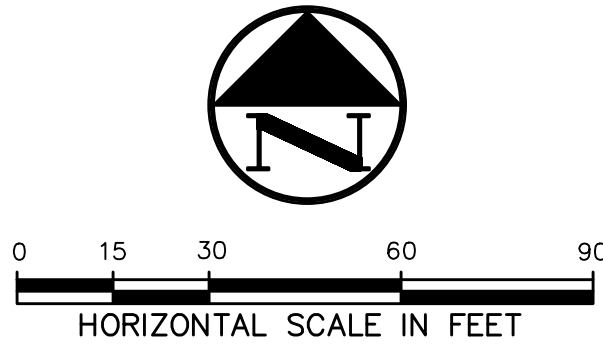

VICINITY MAP
(NOT TO SCALE)

BUILDING SUMMARY TABLE	
A	ADMINISTRATION
B	VISUAL COMMUNICATIONS
C	PERFORMANCE HALL
D	MUSIC
E	EARLY CHILDHOOD EDUCATION
F	FINE ARTS
H	VISUAL COMMUNICATIONS
J	COMPUTER CLASSROOMS
K	MATH SCIENCE
L	LIBRARY LRC
M	BUSINESS DIVISION
P	EARLY COLLEGE HIGH SCHOOL
Q	AUTOMOTIVE TECHNOLOGY
R	FACILITIES SERVICES/RECEIVING
S	STUDENT SERVICES
T	GYMNASIUM PHYSICAL EDU.
U	BROOKHAVEN COURIER
V	EARLY COLLEGE CENTER
W	WORKFORD AND CONTIN. EDU.
X	HEALTH & HUMAN SERVICES

SITE DATA SUMMARY
LOT SIZE: 191.9435 AC (8,361,059 SF)
LAND USE: INSTITUTIONAL - COLLEGE
ZONING: PD-20/R-3

OWNER/DEVELOPER
DALLAS COLLEGE-BROOKHAVEN CAMPUS
3939 VALLEY VIEW LANE
FARMERS BRANCH, TX 75224
PHONE: (214) 918-6228
CONTACT: COREY BLACKBRUN

ENGINEER
PACHECO KOCH CONSULTING ENGINEERS, INC.
7557 RAMBLER RD. SUITE 1400
DALLAS, TEXAS 75231
PHONE: 972-235-3031
CONTACT: EMILY ZOELLNER, P.E.

PART OF DCCD BROOKHAVEN COLLEGE ADDITION
204.6874 ACRES IN THE NOAH GOOD SURVEY,
ABSTRACT NUMBER 520
CITY OF FARMERS BRANCH, DALLAS COUNTY,
TEXAS

PRELIMINARY
NOT FOR CONSTRUCTION
THIS DOCUMENT IS ISSUED FOR THE
PURPOSE OF SCHEMATIC REVIEW ONLY
AND IS NOT INTENDED FOR PERMITTING,
BIDDING, OR CONSTRUCTION PURPOSES.

PLANS PREPARED UNDER THE DIRECT
SUPERVISION OF EMILY M. ZOELLNER, P.E.
TEXAS REGISTRATION NO. 123461
DATE: 09/07/2021

DATE	ACTION
Planning and Zoning Commission Date:	
City Council Date:	
Ordinance No:	
Resolution No:	
Administrative Approval Date:	

ISSUED FOR PRELIMINARY PRICING PURPOSES ONLY
(SUBJECT TO REVISION PRIOR TO CONSTRUCTION)

THESE DOCUMENTS HAVE BEEN PREPARED BY THE ENGINEER WITH THE INTENT OF
COMPLYING WITH ALL CITY STANDARD REQUIREMENTS. THESE DOCUMENTS HAVE
NOT BEEN APPROVED AND RELEASED FOR CONSTRUCTION BY THE CITY AS OF THIS
DATE AND, THEREFORE, REVISIONS MAY BE REQUIRED PRIOR TO CONSTRUCTION.
BY ANY USE OF THESE DOCUMENTS, THE USER AFFIRMS THEIR UNDERSTANDING
OF THE PRELIMINARY STATUS OF THE PLANS AND THE POTENTIAL FOR REVISION
PRIOR TO ANY CONSTRUCTION.

Pacheco Koch
7557 RAMBLER ROAD SUITE 1400
DALLAS, TX 75231 972.235.3031
TX REG. ENGINEERING FIRM F-469
TX REG. SURVEYING FIRM LS-1000800



5646 MILTON STREET, SUITE 426
DALLAS, TEXAS 75206
WWW.GLENN-PARTNERS.COM
COPYRIGHT © 2017 GLENN PARTNERS

EARLY COLLEGE CENTER
DALLAS COLLEGE - BROOKHAVEN CAMPUS
3939 VALLEY VIEW LN.
FARMERS BRANCH, TX 75244

NO	REVISION	DATE

C02-01
CAMPUS SITE
PLAN

DETAILED SITE PLAN
09.03.2021

